



PANEL MOUNTED BLOWN FUSE INDICATING FUSEHOLDER (SINGLE POLE)

MODEL 5600
SINGLE POLE
FOR USE WITH
 $1\frac{3}{32}$ " \times $1\frac{1}{2}$ " FUSES



FEATURES - MODEL 5600 FUSEHOLDER

- A. FITS STANDARD KNOCKOUTS
- B. AVAILABLE WITH OPTIONAL ANTI-ROTATIONAL ADAPTER WASHER
- C. UL COMPONENT RECOGNIZED
- D. MEETS OR SURPASSES NEMA ENVIRONMENTAL REQUIREMENTS
- E. PROVIDES BLOWN FUSE INDICATION ON THE PANEL FRONT

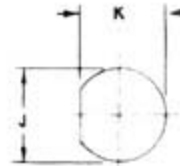
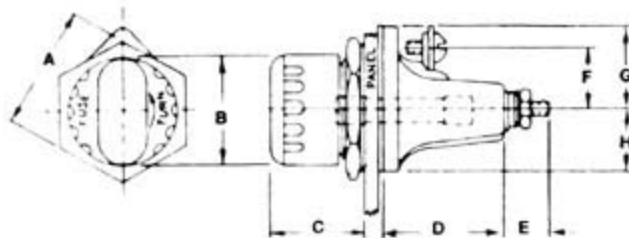

Mounting with optional adapter washer. Specify when ordering.

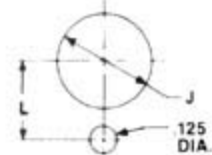

DIMENSIONS

A	B	C	D	E	F	G	H	J	K	L
1.38	1.25	1.12	1.34	.44	.69	.843	.687	1.126	1.067 $\frac{.002}{.000}$.75

SPECIFICATIONS

ELECTRICAL:

Fuse: $1\frac{3}{32}$ " \times $1\frac{1}{2}$ " , 5 AG or Midget Style
Current: 30 AMP any voltage up to 600V. AC or DC (see voltage chart)
Dielectric: withstands 2200 volts

MOLDED PARTS:

Body - Black phenolic
Lens - Polycarbonate
90V & above, clear
Less than 90V, amber **OR CLEAR OPTIONAL**

TERMINALS:

Brass, plated, screw type, #8 side, #10 bottom
Withstand 15 inch pounds torque

FUSECLIP:

Beryllium copper, silver plated

MOUNTING HARDWARE:

Gasket: Silicone
Lockwasher: phos. bronze, plated
Mounting Nut: aluminum, anodized
Optional adapter washer: aluminum, anodized

MOUNTING:

Max panel thickness .125"

CERTIFICATIONS:

UL component recognized & ignition Protected
file no's E41903 & E79894

ENCLOSURE:

Watertight from front of panel

TO ORDER:

- Select the voltage range required from the Voltage Chart, suffix it to the basic P/N (Example: 5600-11)
- If optional adapter washer is req'd suffix **ADP** to P/N as outlined in step 1 (Example: 5600-11ADP)

VOLTAGE CHART

-1	12-22V
-2	23-33V
-3	34-45V
-4	46-60V
-5	61-80V
-6	81-90V
-7	2.5-4V
-8	5-7V
-9	8-11V
-10	1-2.4V
-11	90-250V
-12	90-600V

MODEL 5600 FUSEHOLDER ACCOMMODATES ALL $1\frac{3}{32}$ " \times $1\frac{1}{2}$ " FUSES INCLUDING:

BUSS: BAN, BAF, AGU, FNM, FNO, FWA, FWH, FWX, KAA, KLM, KTK, KAW

GOULD: ATM, A6YT2, A13X

LITTELFUSE: BLF, BLN, FLM, FLO, KLK



FIC CORPORATION
12216 Parklawn Dr.
Rockville, MD 20852

TOLL FREE: 800-638-6594 • IN MD: 301-881-8124 • FAX: 301/881-0530